



Nina Mason Pulliam  
Río Salado  
Audubon Center



Please review the following pages and opine on the survey link  
Por favor, revise las siguientes páginas y opine sobre el enlace de la encuesta

Welcome! Have a Seat.  
Gallery Floorplan

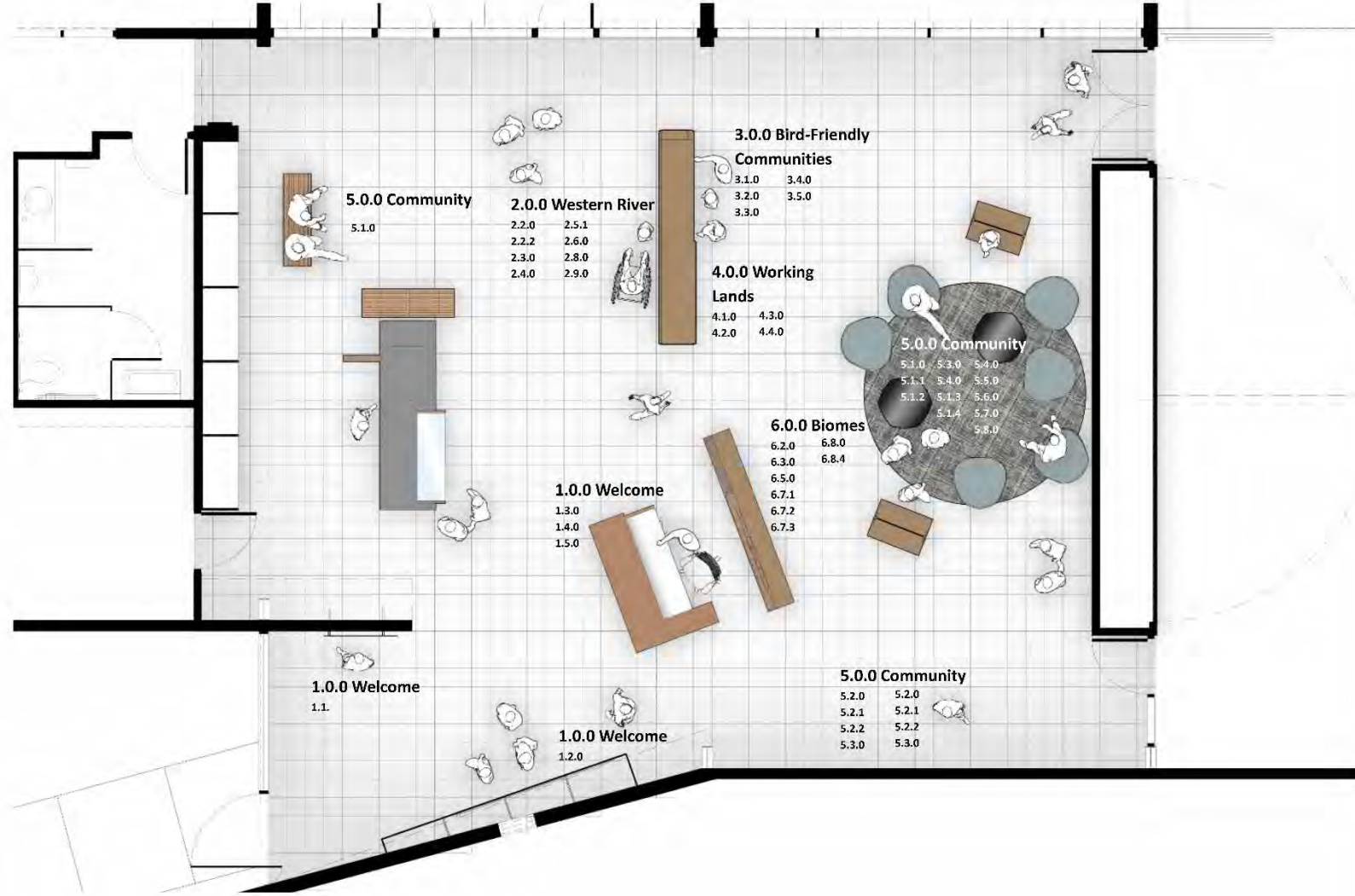

**1.0.0 Welcome**

- 1.1.0 Land Acknowledgement Graphic
- 1.2.0 Map and Donor Recognition
- 1.3.0 Welcome Statement and Graphics
- 1.4.0 Welcome Desk
- 1.5.0 Fabricated Wall

**2.0.0 Western Water**

- 2.2.0 Interactive Western Water Timeline
- 2.2.1 Interactive Western Water AV System
- 2.2.2 Interactive Western Water Enclosure
- 2.3.0 LED Panel Illustrations 1-4
- 2.4.0 Graphic Panels 1-4
- 2.5.1 Capacitive Touch Sensor Graphic
- 2.6.0 Digital Display Screen
- 2.8.0 Fabricated Wall
- 2.9.0 Western Water Header Text Panel

**3.0.0 Bird-Friendly Communities**

- 3.1.0 Bird Friendly Communities Wall Illustration
- 3.2.0 Bird Friendly Communities Printed Mural
- 3.3.0 Trilon Exhibits A-D
- 3.4.0 Bird Friendly Communities Large Interpretive Sign
- 3.5.0 Bird Friendly Communities Header Graphic

**4.0.0 Working Lands**

- 4.1.0 Flip Panel Exhibits A-E
- 4.2.0 Trilon Exhibits E & F
- 4.3.0 Working Lands Large Interpretive Sign
- 4.4.0 Working Lands Header Graphic

**5.0.0 Community**

- 5.1.0 Seating Area
- 5.1.1 Area Carpet (NIC)
- 5.1.2 Seating for 6 (NIC)
- 5.1.3 Storage for baskets & boxes (NIC)
- 5.1.4 Coffee table (NIC)
- 5.2.0 Art Display
- 5.2.1 Wall hanging system (NIC)
- 5.2.2 Lighting for artworks (NIC)
- 5.2.3 Pedestal displays with vitrines (NIC)
- 5.3.0 Interpretive Signage (?)
- 5.4.0 Artist's Mural (NIC)
- 5.5.0 Children's Activity Centers
- 5.6.0 Bird Magnets (Quantity TBD)
- 5.7.0 Community Mural Interpretive Graphic
- 5.8.0 Stroller Parking / Wheelchair Parking Sign

**6.0.0 Biomes**

- 6.2.0 Riparian
- 6.3.0 Upland Sonoran
- 6.5.0 Desert Grassland
- 6.7.1 Printed Wall Graphic Mural
- 6.7.2 Biomes Header
- 6.7.3 Overarching Text
- 6.8.0 Interactive Bird Songs
- 6.8.4 AV Media System for Interactive Bird Songs

Overall Plan

Planear hacer algo



G-A Header



G-B Trilon



G-G QR Code Panel (Text TBD)



G-C Label ID



G-D Extended Label ID



G-E Interpretive Signage



G-F Flip Panel Graphics

## Overall sign design and accessibility services

## Diseño general de señales y servicios de accesibilidad



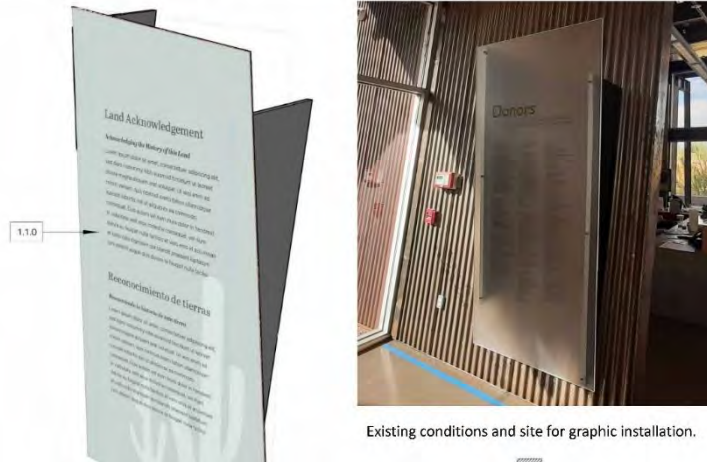
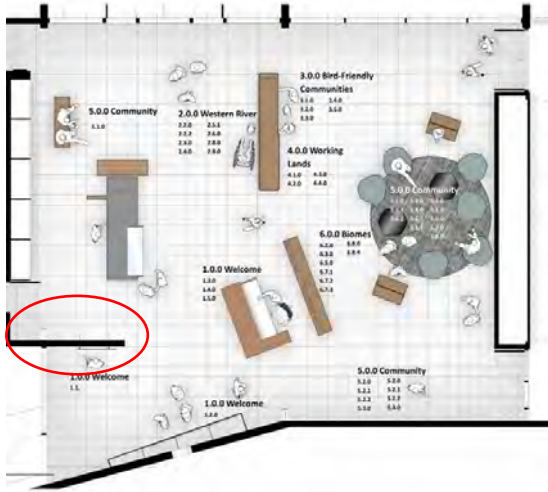

Existing conditions and site for graphic installation.

## Land acknowledgement Reconocimiento de tierras

Draft text: Audubon acknowledges the City of Phoenix is located within the homeland of the O’Odham and Piipaash peoples and their ancestors, who have inhabited this landscape from time immemorial to present day. The landscape is sacred and reflects cultural values central to the O’Odham and Piipaash way of life and their self-definition. This acknowledgment demonstrates our commitment to work in partnership with the Ancestral Indigenous Communities to foster understanding, appreciation, and respect for this heritage. The Salt River Pima-Maricopa Indian Community (SRP-MIC) and the Gila River Indian Community (GRIC) claim aboriginal title (Original Indian Title) to lands exclusively used and occupied by the Akimel O’Odham and Piipaash equaling 3,751,000 acres of South-Central Arizona. Ancestral O’Odham settlements are located throughout the entirety of present-day Phoenix. This land continues to be spiritually connected to the O’Odham of the SRP-MIC and the GRIC, both of which are confederations of two unique cultures with their own languages, customs, cultures, religions, and histories. Both the O’Odham and the Piipaash are oral history cultures and the song cultures of these people are specifically tied to tangible places. These places can be natural landforms like the mountains that surround our valleys, but they also include archaeological sites because they are part of a cultural landscape associated with specific historic, cultural, and religious values. Those places are tangible reminders to the O’Odham and Piipaash about shared attitudes, goals, and practices that characterize who they are, where they belong, and how they related to each other in the past, continuing today and into the future. Audubon is committed to honor the vital meaning and intent of this land acknowledgment statement.

Proyecto de texto: Audubon reconoce que la ciudad de Phoenix se encuentra dentro de la patria de los pueblos O’Odham y Piipaash y sus antepasados, que han habitado este paisaje desde tiempos inmemoriales hasta nuestros días. El paisaje es sagrado y refleja los valores culturales centrales para el estilo de vida O’Odham y Piipaash y su autodefinición. Este reconocimiento demuestra nuestro compromiso de trabajar en asociación con las Comunidades Indígenas Ancestrales para fomentar la comprensión, el aprecio y el respeto por este patrimonio. La Comunidad Indígena Pima-Maricopa de Salt River (SRP-MIC) y la Comunidad India del Río Gila (GRIC) reclaman el título aborigen (Título Indígena Original) a tierras exclusivamente utilizadas y ocupadas por Akimel O’Odham y Piipaash que equivalen a 3,751,000 acres de Sur-Central Arizona. Los asentamientos ancestrales O’Odham se encuentran en todo el mundo. la totalidad del actual Fénix. Esta tierra continúa estando espiritualmente conectada con los O’Odham del SRP-MIC y el GRIC, los cuales son confederaciones de dos culturas únicas con sus propios idiomas, costumbres, culturas, religiones e historias. Tanto los O’Odham como los Piipaash son culturas de historia oral y las culturas de canciones de estas personas están específicamente vinculadas a lugares tangibles. Estos lugares pueden ser accidentes geográficos naturales como las montañas que rodean nuestros valles, pero también incluyen sitios arqueológicos porque son parte de un paisaje cultural asociado con valores históricos, culturales y religiosos específicos. Esos lugares son recordatorios tangibles para los O’Odham y Piipaash sobre actitudes, objetivos y prácticas compartidas que caracterizan quiénes son, a dónde pertenecen y cómo se relacionaron entre sí en el pasado, continuando hoy y en el futuro. Audubon se compromete a honrar el significado vital y la intención de esta declaración de reconocimiento de tierras.



Nina Mason Pulliam  
Rio Salado  
Audubon Center



Nina Mason Pulliam  
Rio Salado  
Audubon Center

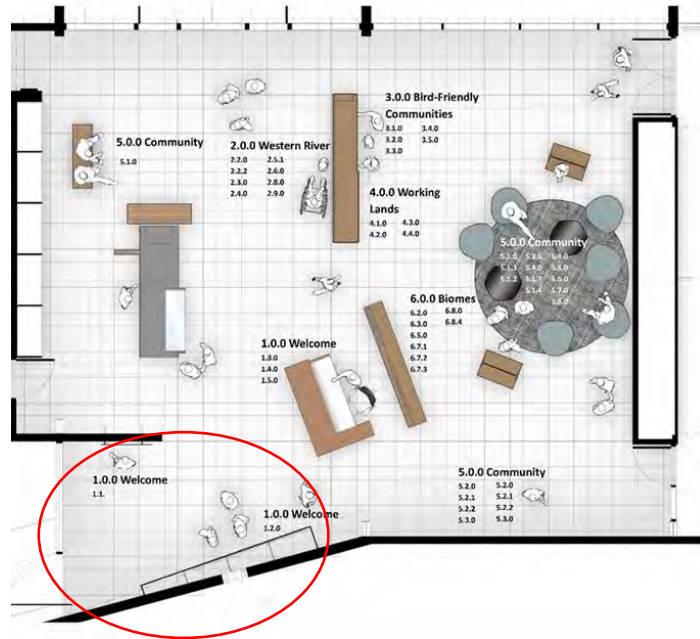

Map of the Rio Salado park & trails  
Donor thank you panel

### 1.2.0 Map and Donor Recognition

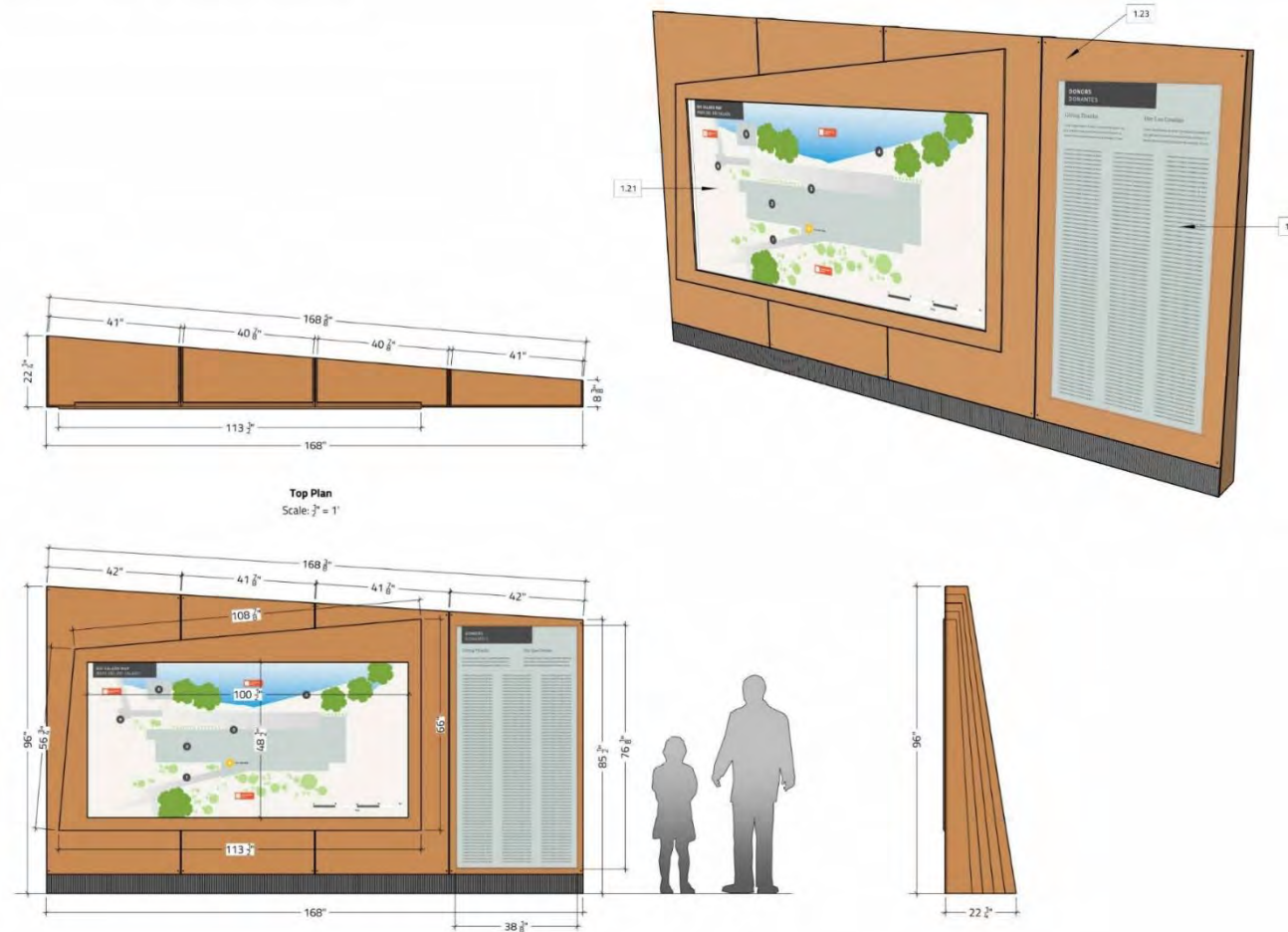

Mapa del parque y senderos de Río Salado Panel de agradecimiento de donantes

1.0 Welcome Area

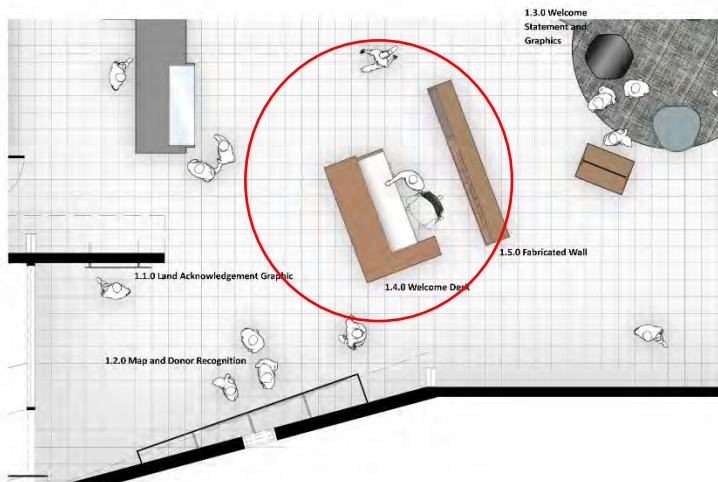

6.0 Biomes

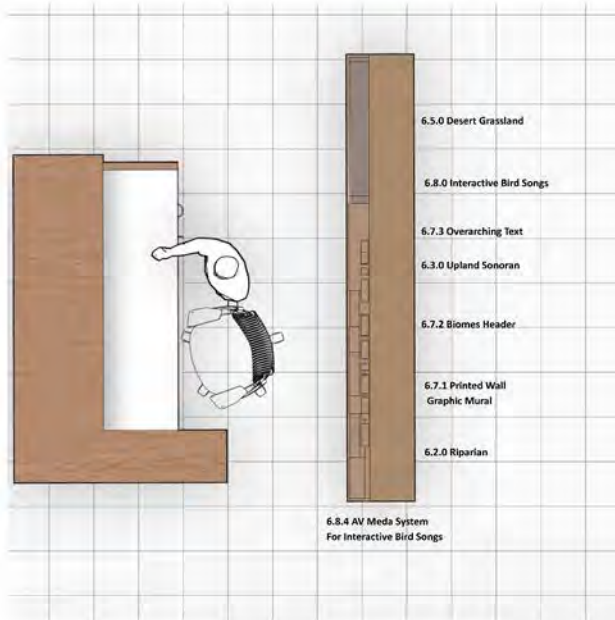

1.3.0 Welcome Statement & Graphics



Nina Mason Pulliam  
Rio Salado  
Audubon Center

Welcoming desk with collage of photos and welcome text

Mostrador de bienvenida con collage de fotos y texto de bienvenida

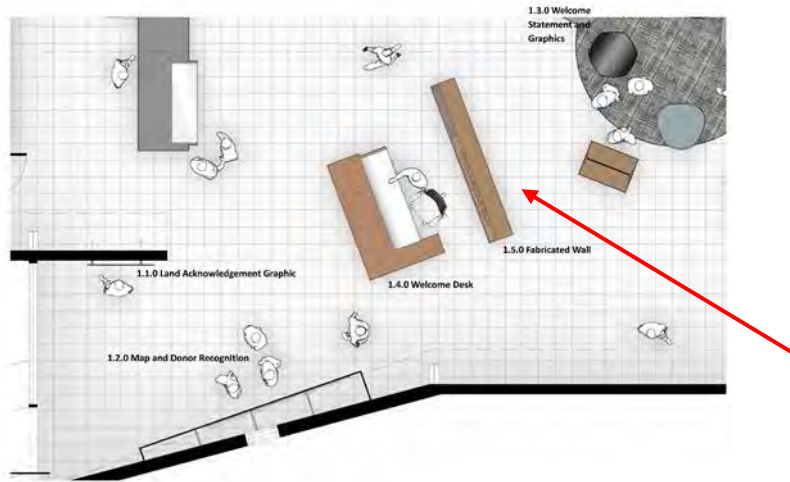

## Backside of the welcome desk

Three central AZ biomes: riparian, Sonoran desert, and grassland with birds to touch and hear sounds.

## Parte trasera de la pared del mostrador de bienvenida

Tres biomas centrales de Arizona: ribereño, desierto de Sonora y pastizales con aves para tocar y escuchar sonidos.

6.8.c



RIPARIAN

- 6.8.1.1 Red Winged Blackbird
- 6.8.1.2 Common Yellow-throat
- 6.8.1.3 Yellow Warbler
- 6.8.1.4 Lesser Goldfinch
- 6.8.1.5 Song Sparrow

SONORAN DESERT

- 6.8.2.1 Cactus Wren
- 6.8.2.2 Gambel's Quail
- 6.8.2.3 Verdin
- 6.8.2.4 House Finch
- 6.8.2.5 Gila Woodpecker
- 6.8.2.6 Elf Owl
- 6.8.2.7 White Winged Dove

DESERT GRASSLANDS

- 6.8.3.1 Western Kingbird
- 6.8.3.2 Western Meadowlark
- 6.8.3.3 Scott's Orioles
- 6.8.3.4 Burrowing Owl



Performance Description

All 3D birds included in the interactive, and integrated into the illustrated mural graphic, are capacitive touch sensors. When a visitor touches a bird, a light goes on and halo-lights that bird. Simultaneously, that bird song is audible to visitors near to the exhibit. Only one birdsong, and accompanying bird "glow," can be activated at one time. When the bird song concludes, the light deactivates and the visitor can activate that, or any other bird song, by touching that bird.

Volume for this exhibit can be manually changed or muted as needed.

6.7.1 Printed Wall Graphic Mural / 6.7.2 Biomes header / 6.7.3 Biomes Overarching Text

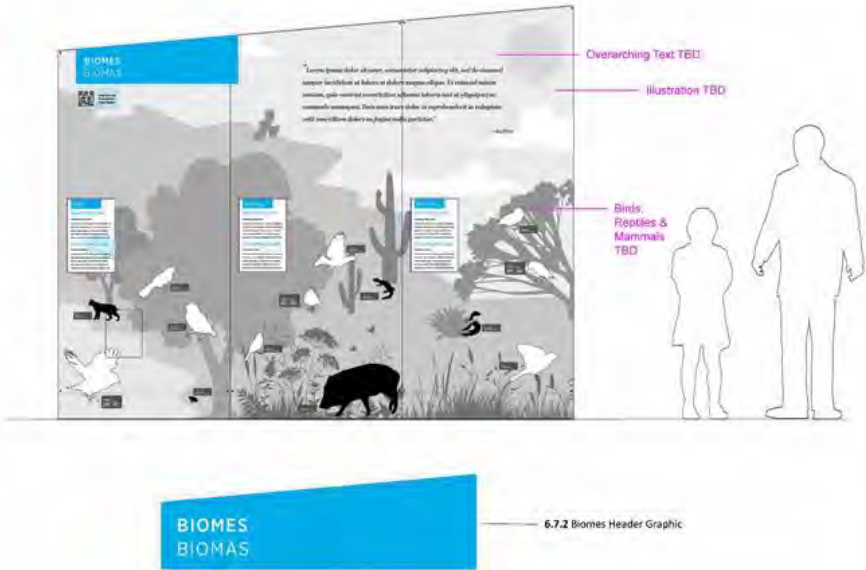

Specifications for Graphic Production

- 6.7.1 Printed Wall Graphic Mural
  - Custom printed mural graphic on adhesive backed vinyl installed by signage contractor like wallpaper.
- 6.7.2 Biomes Header Graphic
  - Value engineered Printed vinyl cut to trapezoidal shape and applied to a 1/2" board substrate, black sintra
  - Ideal Direct print panel with cut negative letters applied over white painted area on surface of exhibit.
- 6.7.3 Overarching Text
  - TBD - Could be integrated into 6.7.1
- 6.7.4 Biomes 3D Profile Cut & Layered Species (quantity of 14, various sizes TBD)
  - Value Engineered Printed vinyl on 1/2" or 3/4" thick board substrate with custom color painted edge
  - Alternate 1/2" thick profile cut acrylic with second surface printed graphics and softened edges adhered on top of painted, 1/2" MDF profile-cut shape
  - Ideal Areas of the mural in all three sections of habitat are printed in color relief for touch sensory experience and experience for the sight impaired

## Bench Seating

## Asientos de banco

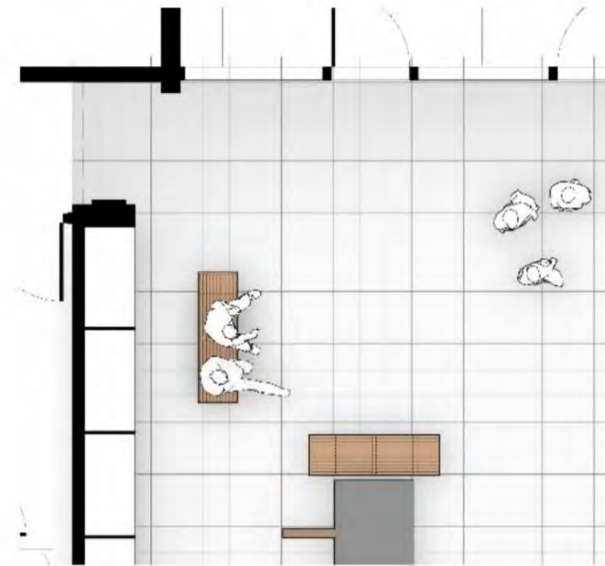
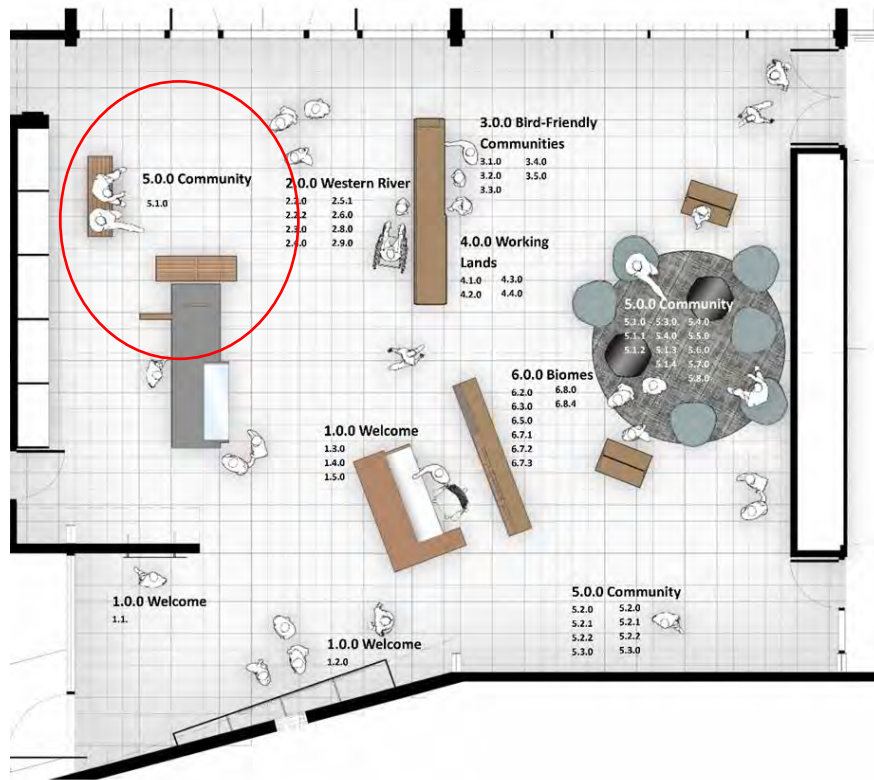

5.10.0 Small Seating Area (NIC)  
Quantity of 2





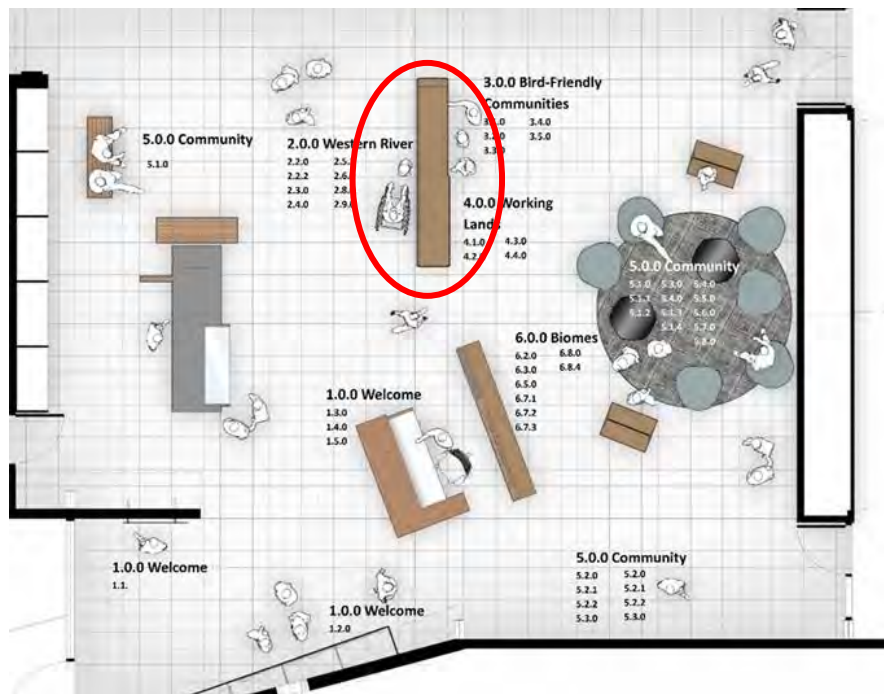

This two-sided piece shares work Audubon Southwest does

Esta pieza de dos caras comparte el trabajo que Audubon Southwest hace

2.0 Western Water / 3.0 Bird Friendly Communities / 4.0 Working Lands

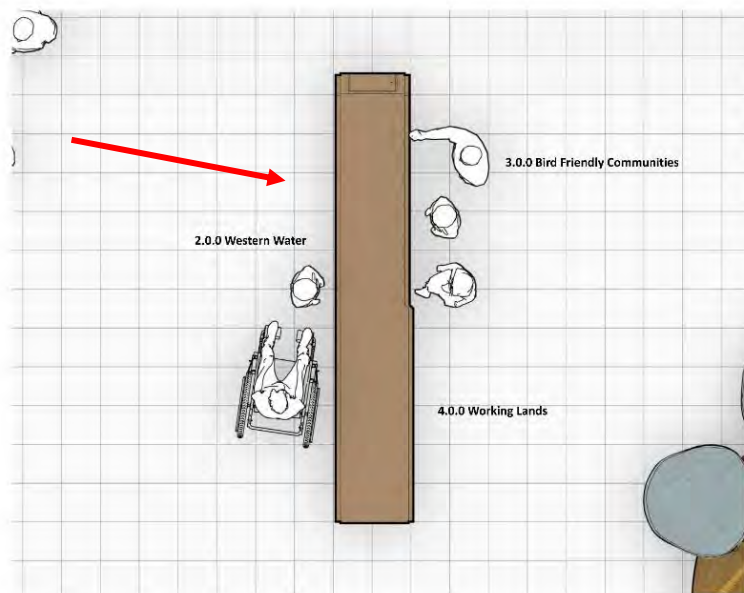

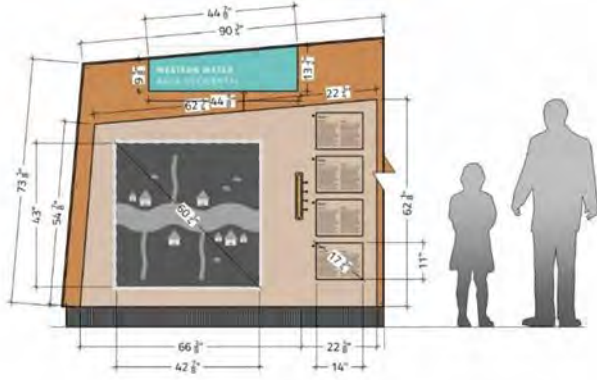

**Side 1: Western Water interactive—story of the Rio Salado and upcoming events screen and slide show**

**Cara 1: Western Water interactive: historia del Río Salado y próximos eventos pantalla y presentación de diapositivas**

2.3.0 LED Panel Illustrations 1 - 4



2.3.1 LED Panel: Illustrated Image 1 - Pre-Settlement



2.3.2 LED Panel: Illustrated Image 2 - Early Days



2.3.3 LED Panel: Illustrated Image 3 - Drowning



2.3.4 LED Panel: Illustrated Image 4 - Today

Illustrations Descriptions

43" x 45" Ill. strators made from steel  
 illustrations on the left

Depictions include:

- Pre-Settlement: Houses, Arroyo San Diego
- Post-Settlement: River, Arroyo San Diego
- Early Settlement: Dwellings
- Early River: Agriculture
- Today: Settler Dwellings
- Canal
- Dam
- Reservoir



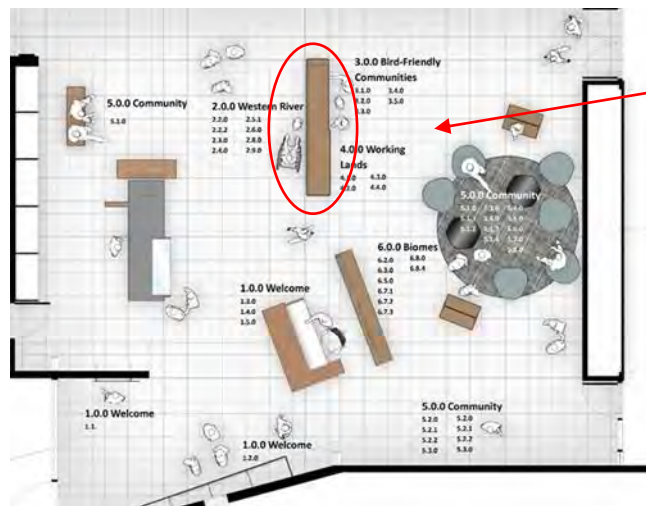

## Backside interactives: Bird Friendly Communities and Working Lands

Interactivos traseros:  
comunidades amigables  
con las aves y tierras de  
trabajo

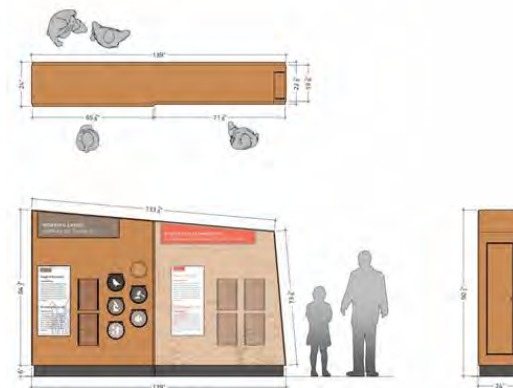

### Components of Exhibit Experience

- 3.0 Bird-Friendly Communities
- 3.1.0 Bird Friendly Communities Wall Illustration
- 3.2.0 Bird Friendly Communities Printed Mural
- 3.3.0 Trilon Exhibits A-D
- 3.4.0 Bird Friendly Communities Large Interpretive Sign
- 3.5.0 Bird Friendly Communities Header Graphic
- 4.0 Working Lands
- 4.1.0 Flip Panel Exhibits A-E
- 4.2.0 Trilon Exhibits E & F
- 4.3.0 Working Lands Large Interpretive Sign
- 4.4.0 Working Lands Header Graphic
- 4.5.0 Working Lands Flip Overview Panel

### 3.0 Bird Friendly Communities

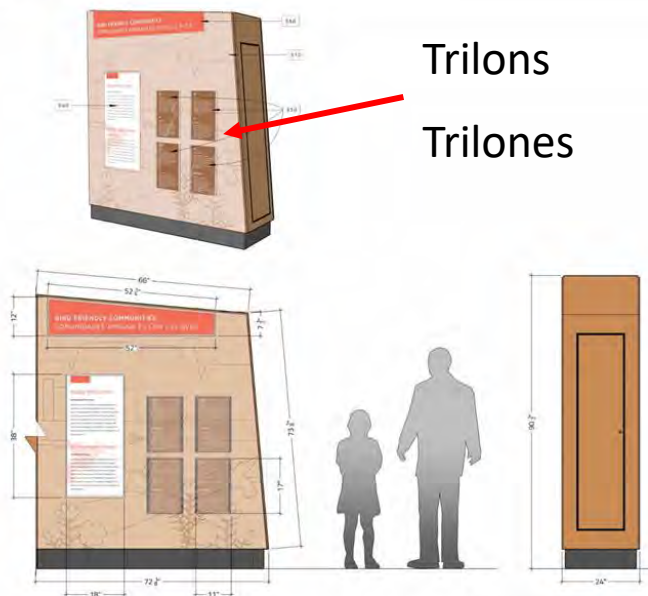

Trilons  
Trilones

### Components of Exhibit Experience

- 3.0 Bird-Friendly Communities
- 3.1.0 Bird Friendly Communities Wall Illustration
- 3.2.0 Bird Friendly Communities Printed Mural
- 3.3.0 Trilon Exhibits A-D
- 3.4.0 Bird Friendly Communities Large Interpretive Sign
- 3.5.0 Bird Friendly Communities Header Graphic

Trilons are 3-  
sided features  
that visitors  
turn

Los trilones son  
características  
de 3 lados que  
los visitantes  
giran

### 3.3.0 Trilon Exhibits

#### 3.3.1 Fabricated Trilon A



#### 3.3.1 Fabricated Trilon B



#### 3.3.1 Fabricated Trilon C



#### 3.3.1 Fabricated Trilon D

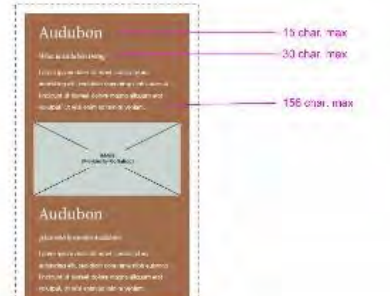
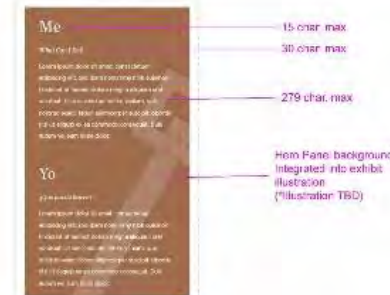

# Working Lands

## Tierras de trabajo

3.2.0 10 x 10 Display Corner wall to fit wall to wall

- Custom printed inlay graphic on substrate cut into vinyl cuttable by shape to allow for the wall corner

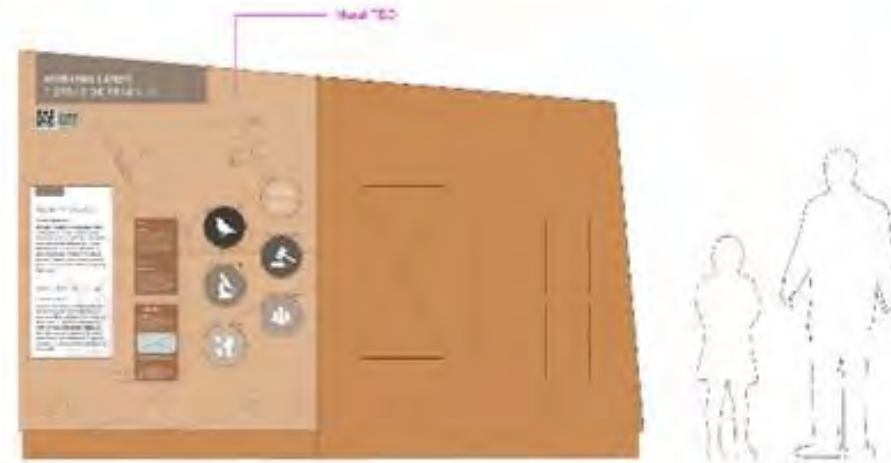

4.0.0 Working Lands

4.0.0 Working Lands

**WORKING LANDS**  
TIERRAS DE TRABAJO

4.0.0 Working Lands Header Graphic

Header Will Go Here  
19 char. max  
30 char. max  
445 char. max

**Subheading Will Go Here**  
19 char. max  
30 char. max  
445 char. max

El encabezado irá aquí

3.1.0 Working Lands Wall Illustration  
(Simple Illustration TCO)

Specifications for Graphic Production

4.0.0 Working Lands

4.3.0 Working Lands Large Interpretive Sign

- *Value engineered*  
Printed vinyl on 1/8" sintra substrate, black
- *Material*  
Direct print area around surface of 1/2" thick acrylic

4.4.0 Working Lands Header Graphic

- *Value engineered*  
Printed vinyl cut to trapezoidal shape and applied to a 1/2" board substrate, black sintra
- *Material*  
Direct print panel with cut negative letters applied over white painted area on surface of exhibit.

Flip panels  
Paneles abatibles



ideum

4.0.0 Working Lands

4.3.0 Working Lands Flip Panel Exhibit

Graphic TCO

11 char. max  
100 char. max

100

Community seating area  
área femenino

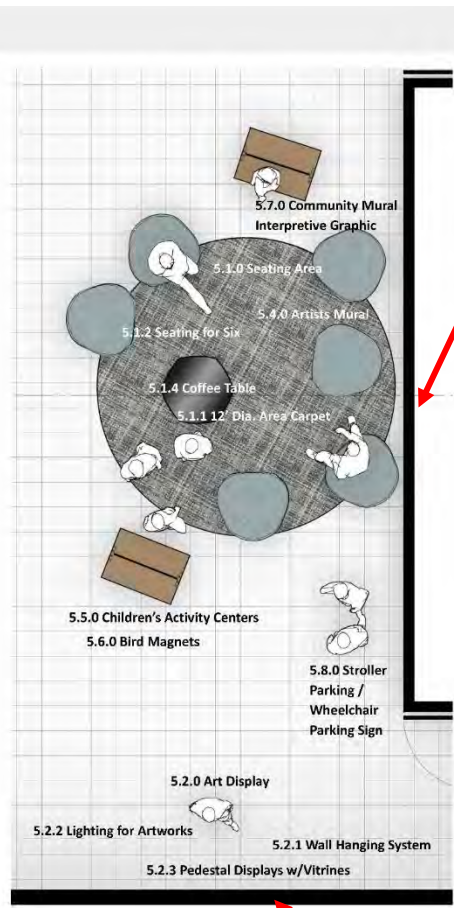
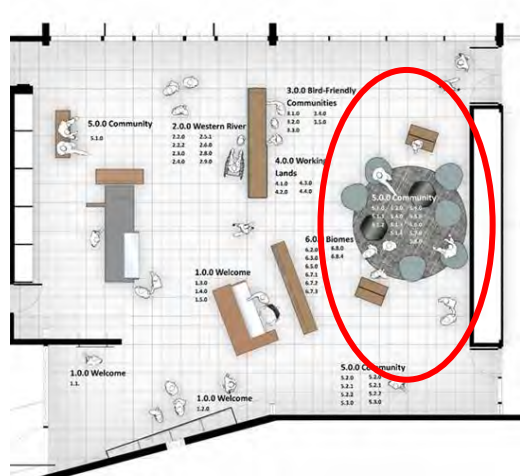

Mural by The Sagrado  
Mural de El Sagrado

**5.1.0 Seating Area**

**5.5.0 Activity Centers**  
Quantity of 2

**Components of Exhibit Experience**

- 5.1.0 Seating Area
- 5.1.1 Area Carpet (NIC)
- 5.1.2 Seating for 6 (NIC)
- 5.1.3 Storage for baskets & boxes (NIC)
- 5.1.4 Coffee table (NIC)
- 5.5.0 Activity Centers
- 5.9.0 Area Pendant Lighting (NIC)

**5.1.1 Area Carpet (NIC)**  
Circular Carpet, 12' Diameter

**5.1.2 Seating for Six (NIC)**

Chair Fabric Textile  
Hemix 9 - 923

**5.1.4 Coffee Table (NIC)**  
Quantity of 2

**5.9.0 Area Pendant Lighting (NIC)**

**5.5.0 Children's Activity Centers / 5.6.0 Bird Magnets**

**Recommended Purchases: (NIC)**

- Magnetic Whiteboard
- Magnetic Storage Tray
- Note Cards
- Golf Pencils

**Components of Exhibit Experience**

- 5.5.0 Activity Centers
- Aluminum chainlink
- Color Hex ID-ACAD001
- 1/2" Thick MDF Panel (Gambrell)
- 5.6.0 Bird Magnets (Quantity TBD)
- Printed available graphic applied to thin magnet
- Black sticks to stick magnet on Children's Activity Center
- Photographic bird images provided by Audubon
- Common names, in English and Spanish, transcribed into graphic design. With a photo credit, if required. These will be displayed seasonally.

**5.1.3 Storage for Baskets & Boxes**

Soft Storage Fabric Bin



Art display space  
Espacio de exhibición de arte